

NEXT

QUICK SETUP GUIDE

Joy-Con 2 Charging Station For Nintendo Switch 2 NX-NS2JQC

PACKAGE CONTENTS

- Joy-Con 2 Charging Station

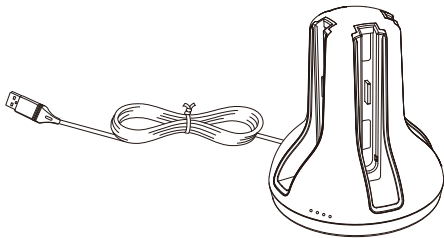

Before using your new product, please read these instructions to prevent any damage.

FEATURES

- Charges up to four Joy-Con 2 simultaneously
- Individual LEDs indicate the charge level for each controller
- Weighted base for stability

SAFETY INFORMATION

- Do not disassemble any of the components. Refer all services to qualified personnel only.
- Do not place or store the product in a humid area and do not expose it to water or rain.
- Use the product only as instructed. Read all instructions before operating the product.
- Failure to follow these directions may void the warranty.

SETTING UP THE CHARGING STATION

- 1 Plug the charge station cable into the USB port of the Switch 2 Dock or any compatible USB Type A charging adapter.

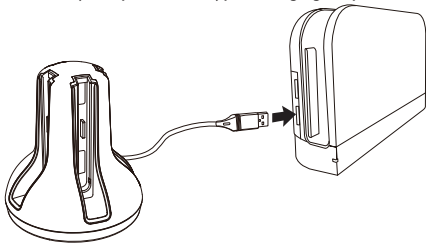

- 2 Attach your Joy-Con 2 controller into the corresponding colored charging slot on the charge station. The LED indicator corresponding slots numbered lights up amber when the controller is properly connected.

Note: Make sure your Joy-Con 2 controller is connected in an upright position to charge.

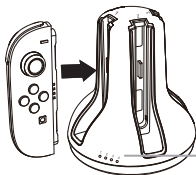

STATUS LED	DESCRIPTION
Amber	Charging in process
Green	Charging complete



SPECIFICATIONS

Dimensions (W×H×D)	4.5 x 4.5 x 1.8in. (11.5 x 11.5x 5cm)
Cable length	2.6ft (80cm)
Input	USB 5V,3A
Output - Charging station:	5V 200mA x 4
Operating temperature	32°F~104°F (0°C~40°C)

TROUBLESHOOTING

The charging station doesn't charge?

- Make sure the Joy-Con 2 controllers are placed in an upright position when connected into the charging slots.
- Verify that the charge station is plugged into a powered USB port.
- Unplug the charging station's USB power cable and plug it back in.
- Original Joy-Con controllers from Switch 1 will not charge - ensure you are only attempting to charge Joy-Con 2 controllers.
- Ensure that you have matched up the inside color of your Joy-Con 2 controller with the color on the charge station (orange with orange, blue with blue).

LEGAL NOTICES

FCC Information

This device complies with part 15 of the FCC Rules. Operation is subject to the following two conditions: (1) This device may not cause harmful interference, and (2) this device must accept any interference received, including interference that may cause undesired operation.

Warning: Changes or modifications to this unit not expressly approved by the party responsible for compliance could void the user's authority to operate the equipment.

Note: This equipment has been tested and found to comply with the limits for a Class B digital device, pursuant to Part 15 of the FCC Rules. These limits are designed to provide reasonable protection against harmful interference in a residential installation. This equipment generates, uses and can radiate radio frequency energy and, if not installed and used in accordance with the instructions, may cause harmful interference to radio communications. However, there is no guarantee that interference will not occur in a particular installation. If this equipment does cause harmful interference to radio or television reception, which can be determined by turning the equipment off and on, the user is encouraged to try to correct the interference by one or more of the following measures:

- Reorient or relocate the receiving antenna.
- Increase the separation between the equipment and receiver.
- Connect the equipment into an outlet on a circuit different from that to which the receiver is connected.
- Consult the dealer or an experienced radio/TV technician for help.

ONE-YEAR LIMITED WARRANTY

Visit www.next-accessories.com for details.

This product is not approved, endorsed or affiliated with Sony.

©2025. All Rights Reserved.

Made in China

English V2-25-0729